

HEAVY-DUTY T-SLOT NUT 8 WITH BALL AND BAR (WITH SPRING BALL)

Available with various thread sizes

T-slot nuts are inserted into the end of the profile slot

A spring-loaded ball holds the T-slot nut in the desired position after it has been inserted

Heavy-duty T-slot nuts are ideal for higher loads

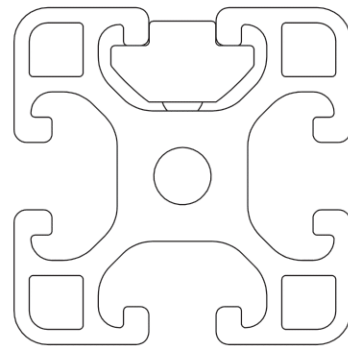
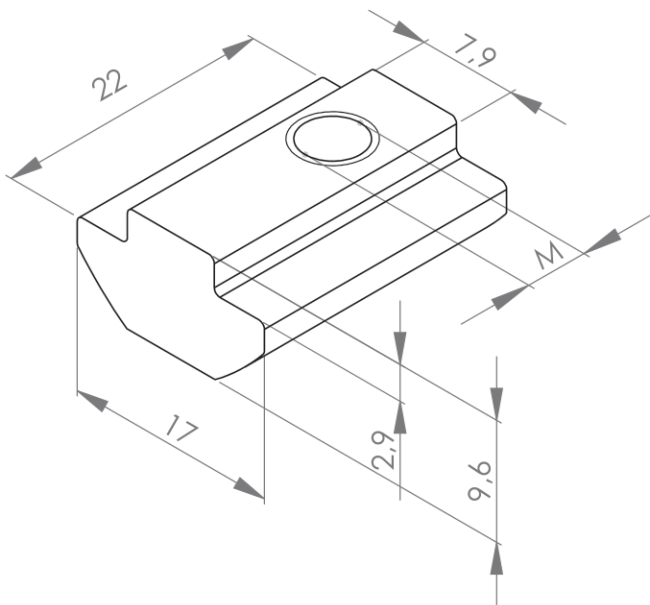

Positioning the T-slot nut

Description	Slot	M (mm)	Material	Weight (g)	ESD	Art. no.:
Heavy duty T-slot nut 8 with bar and bar (with spring ball)	8	M4	Steel, zinc-plated	19.1	-	356030
	8	M5	Steel, zinc-plated	18.5	-	356040
	8	M6	Steel, zinc-plated	17.8	-	356050
	8	M8	Steel, zinc-plated	16.1	-	356060