

HEAVY-DUTY T-SLOT NUT 8 WITHOUT BAR (WITH SPRING BALL)

Available with various thread sizes

T-slot nuts are inserted into the end of the profile slot

A spring-loaded ball fixes the T-slot nut in the desired position after it has been inserted

Heavy-duty T-slot nuts are ideal for higher loads

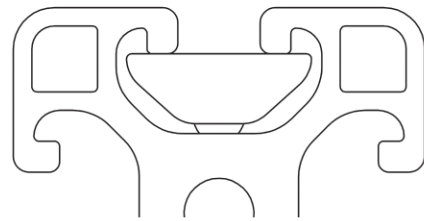
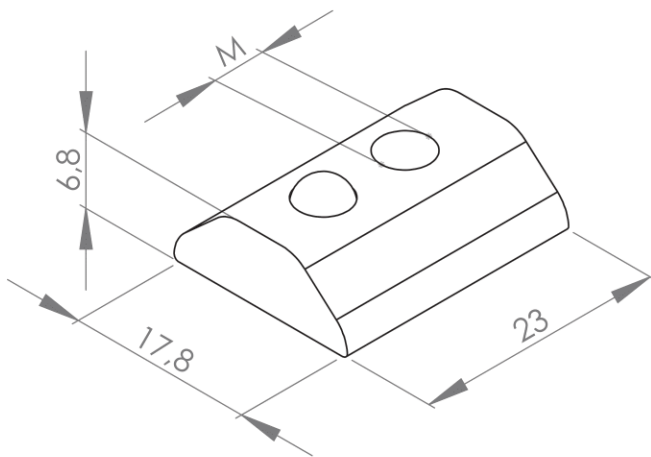

Positioning the T-slot nut

Description	Slot	M (mm)	Material	Weight (g)	ESD	Art. no.:
Heavy duty T-slot nut 8, without bar (with spring ball)	8	M3	Steel, zinc-plated	14.8	-	356005
	8	M4	Steel, zinc-plated	14.8	-	356010
	8	M5	Steel, zinc-plated	13.7	-	356020