



## JOINTS WITH AND WITHOUT CLAMPING LEVERS







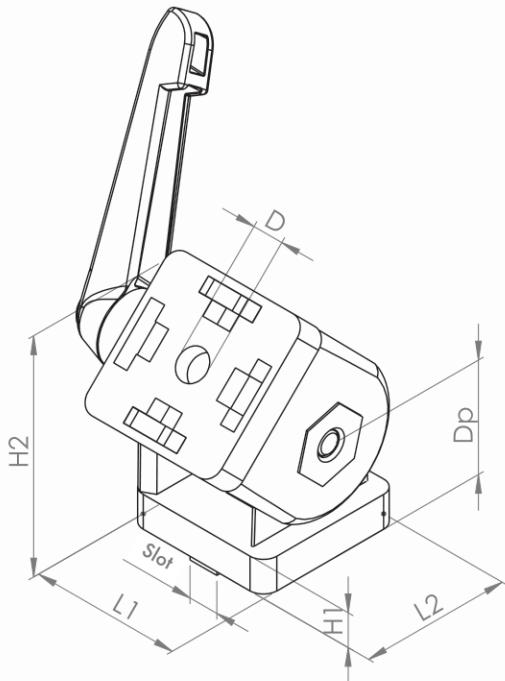

Joint material: die-cast aluminium | die-cast zinc, aluminium colour, powder-coated

Clamping lever material: Plastic, PA, black | aluminium colour, powder-coated

With slot centring pieces, slot 8 / slot 10



- For swivelling connection of two elements.
- Can be used to fix two elements at the desired angle
- Joints with clamping levers can be used as mitre connectors
- Suitable for end-to-end and end-to-side connections

Description	L1 (mm)	L2 (mm)	Slot (mm)	Ø (D) (mm)	H1 (mm)	H2 (mm)	Dp (mm)	Clampable	Weight (g)	ESD	Art. no.:
Joint 5 20x20	20	20	5	5.2	5	30	25	Y*	37.1		426004
Joint 5 20x20 with clamping lever	20	20	5	5.2	5	30	25	Y*	55.0		426002
Joint 6 30x30	30	30	6	8.3	7	45	26	N*	128.4		426005
Joint 6 30x30 with clamping lever	30	30	6	8.3	7	45	26	Y*	166.3		426007
Joint 8 40x40	40	40	8	8.3	9	60	30	N*	297.2		426010
Joint 8 40x40 with clamping lever	40	40	8	8.3	9	60	30	Y*	380.7		426020
Joint 8 40x80	40	80	8	8.3	9	100	50	Y*	1011.7		426030
Joint 8 40x80 with clamping lever	40	80	8	8.3	9	100	50	Y*	1151.2		426040

\* Y = YES

\* N = NO