

## PROFILE 8 40x40L R40/80 - 60° (light)

Material: anodised aluminium

### Technical data:

Surface A [cm <sup>2</sup> ]	10.50
Moment of inertia I <sub>x</sub> [cm <sup>4</sup> ]	22.64
Moment of inertia I <sub>y</sub> [cm <sup>4</sup> ]	34.92
Section modulus W <sub>x</sub> [cm <sup>3</sup> ]	5.96
Section modulus W <sub>y</sub> [cm <sup>3</sup> ]	11.56
Weight m [kg/m]	2.82

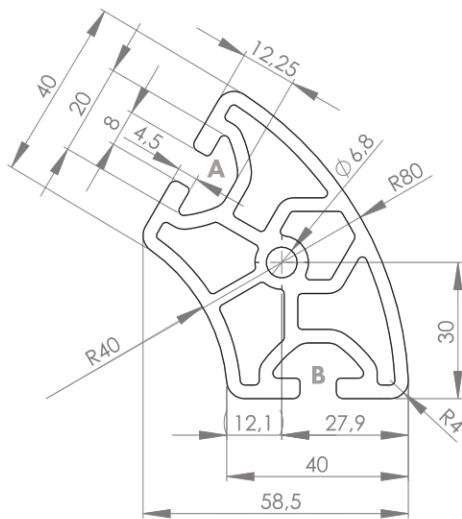

Standard processing:	Art. no.:
M8 / -	103200
M8 / M8	103205

Explanations and further processing options can be found on p. 223-231

Dimensions (version)	Length (mm)	Slot	Weight (kg)	Art. no.:
40x40L R40/80 - 60°	Cut to length	8	2.82 kg/m	20207500
40x40L R40/80 - 60°	6060	8	2.82 kg/m	20207501

If this profile is cut to length, the cutting costs incurred per saw cut must be factored in. (Art. no.: 101020)

## COVER CAP 8 R40/80 - 60°

Material: PA plastic



Dimensions (version)	Slot	Weight (g)	Version	Art. no.:
R40/80 - 60°	8	7.8	Black	421045