

PROFILE 8 80x80

Material: anodised aluminium

Technical data:

Surface A [cm ²]	20.10
Moment of inertia I _x [cm ⁴]	188.05
Moment of inertia I _y [cm ⁴]	188.05
Section modulus W _x [cm ³]	47.01
Section modulus W _y [cm ³]	47.01
Weight m [kg/m]	7.17

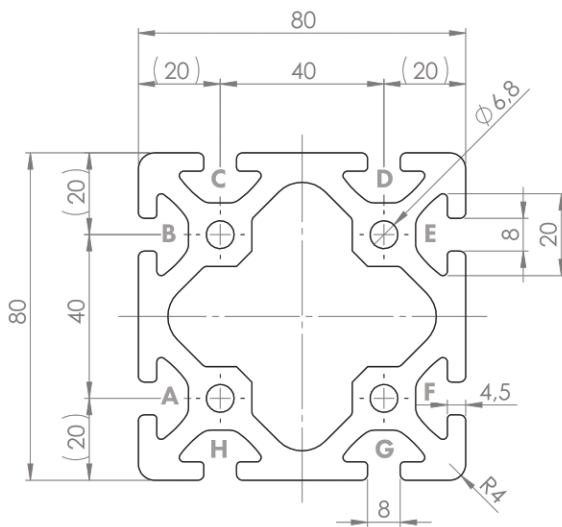

Standard processing:	Art. no.:
M8= / -	103215
M8= / M8=	103210
M8# / -	103240
M8# / M8#	103245
D7= / -	102354
D7= / D7=	102355
D7= / D7V=	102362
D7# / -	102360
D7# / D7#	102365
D7# / D7V#	102367
D14= / -	102460
D14= / D14=	102465
D14= / D14V=	102467

Explanations and further processing options can be found on p. 223-231

Dimensions (version)	Length (mm)	Slot	Weight (kg)	Art. no.:
80x80	Cut to length	8	7.17 kg/m	20209100
80x80	3060	8	7.17 kg/m	20209103
80x80	6060	8	7.17 kg/m	20209101

If this profile is cut to length, the cutting costs incurred per saw cut must be factored in. (Art. no.: 101030)

COVER CAP 8 80x80

Material: PA plastic

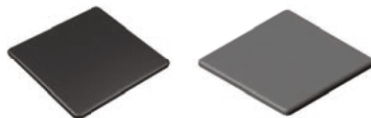

Dimensions (version)	Slot	Weight (g)	Version	Art. no.:
80x80	8	19.4	Black	421060
80x80	8	19.4	Grey (similar to RAL 7042)	99900855