



PROFILE 5 40x40

Material: anodised aluminium

Technical data:

Surface A [cm ²]	5.14
Moment of inertia I _x [cm ⁴]	9.33
Moment of inertia I _y [cm ⁴]	9.33
Section modulus W _x [cm ³]	4.62
Section modulus W _y [cm ³]	4.62
Weight m [kg/m]	1.39

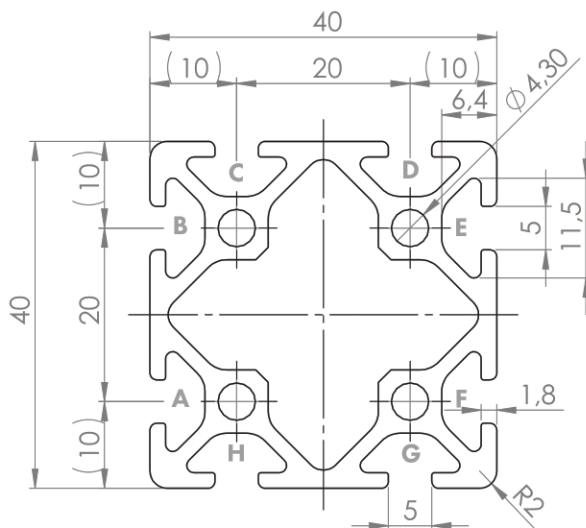

Standard processing:	Art. no.:
M5# / -	103176
M5# / M5#	103177
D4.5= / -	102177
D4.5= / D4.5=	102180
D4.5= / D4.5V	102181
D4.5# / -	102190
D4.5# / D4.5#	102192
D4.5# / D4.5V#	102195
D12=(Uni) / -	102439
D12=(Uni) / D12=(Uni)	102442
D12=(Uni) / D12V=(Uni)	102444

Explanations and further processing options can be found on p. 223-231

Dimensions (version)	Length (mm)	Slot	Weight (kg)	Art. no.:
40x40	Cut to length	5	1.39 kg/m	20203100
40x40	6060	5	1.39 kg/m	20203101

If this profile is cut to length, the cutting costs incurred per saw cut must be factored in. (Art. no.: 101020)

COVER CAP 5 40x40

Material: PA plastic

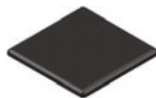

Dimensions (version)	Slot	Weight (g)	Version	Art. no.:
40x40	5	1.8	Black	421026