

PROFILE CONNECTORS

Material: Steel, zinc-plated

The item is delivered pre-assembled.

For connecting two profiles abutting each other end to end.
No profile processing is required. The profile connectors can simply be pushed into the profile slot on the end face.

344005

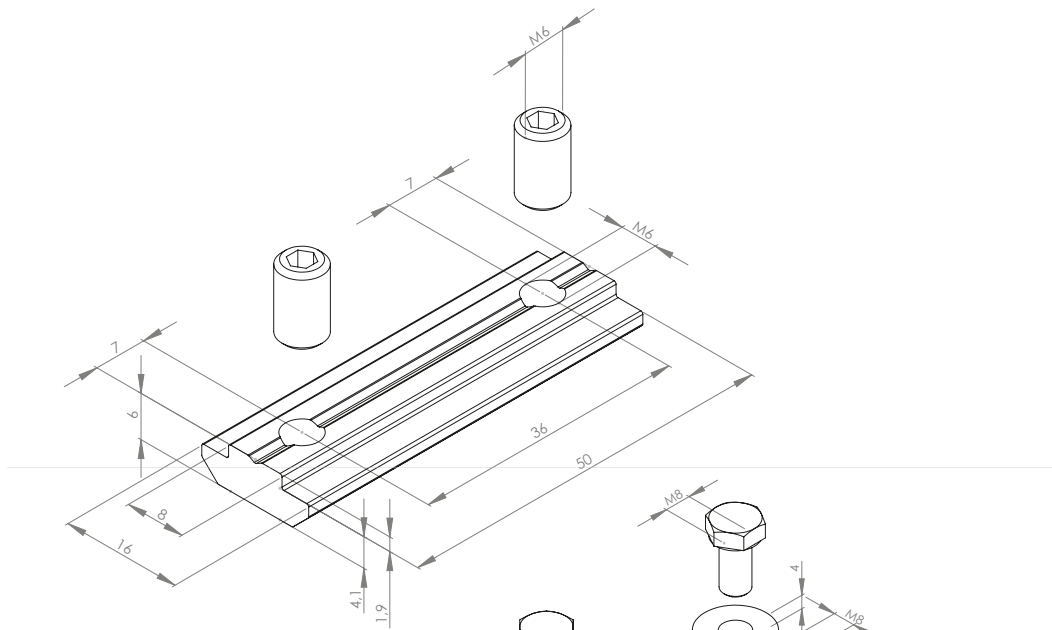

344011

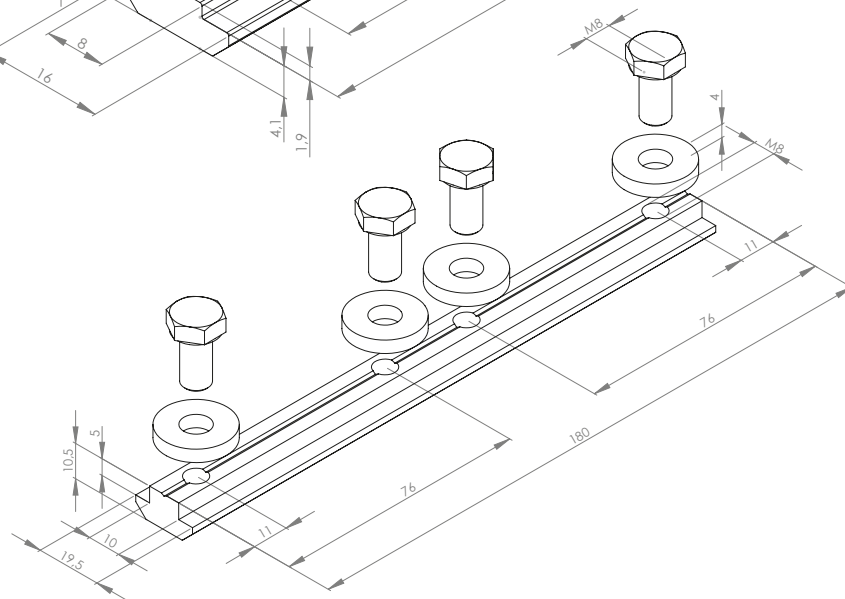

| Description | Length (mm) | Slot | Thread (M) | Version | Weight (g) | Series | Art. no.: |
|---|-------------|------|------------|--|------------|-----------|---------------|
| Profile connector slot 8 2xM6 | 50 | 8 | M6 | With fastening kit* | 29.0 | (i) (B) | 344005 |
| Profile connector slot 10 | 180 | 10 | M8 | With fastening kit** | 254.0 | (B) | 344011 |
| Fastening kit:* | | | | Fastening kit:** | | | |
| 1x profile connector slot 8, steel, zinc-plated | | | | 1x T-slot nut slot 10 L=180, St zinc-plated | | | |
| 2x grub screws DIN 913-M6x10, St, zinc-plated | | | | 4x hexagon head screws DIN 933-M8x16, St zinc-plated | | | |
| | | | | 4x washers DIN 7349 Ø8.4, St zinc-plated | | | |
| | | | | 4x lock washers S8 | | | |