



## PROFILE 6 30x12L (light)

Material: anodised aluminium

### Technical data:

Surface A [cm <sup>2</sup> ]	1.58
Moment of inertia I <sub>x</sub> [cm <sup>4</sup> ]	0.25
Moment of inertia I <sub>y</sub> [cm <sup>4</sup> ]	1.46
Section modulus W <sub>x</sub> [cm <sup>3</sup> ]	0.39
Section modulus W <sub>y</sub> [cm <sup>3</sup> ]	0.98
Weight m [kg/m]	0.43

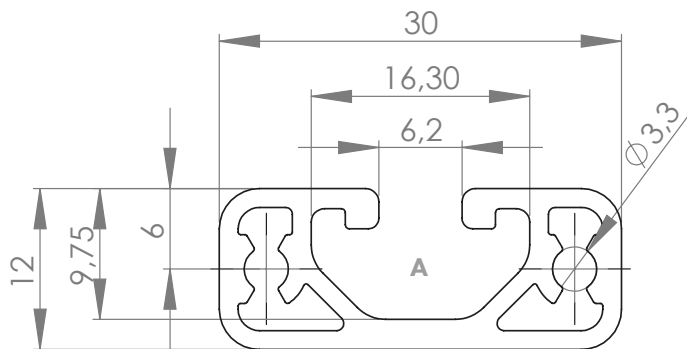

Standard processing:	Art. no.:
-	-

Explanations and further processing options can be found on p. 223-231

Dimensions (version)	Length (mm)	Slot	Weight (kg)	Art. no.:
30x12L	Cut to length	6	0.43 kg/m	20201500
30x12L	6060	6	0.43 kg/m	20201501

If this profile is cut to length, the cutting costs incurred per saw cut must be factored in. (Art. no.: 101010)

## COVER CAP 6 30x12

Material: PA plastic



Dimensions (version)	Slot	Weight (g)	Version	Art. no.:
30x12	6	2.6	Black	421029