



## PROFILE 20x20 2N90 SLOT 6

Material: anodised aluminium



### Technical data:

|   |      |
|---|------|
| Surface A [cm <sup>2</sup> ]                        | 1.80 |
| Moment of inertia I <sub>x</sub> [cm <sup>4</sup> ] | 0.70 |
| Moment of inertia I <sub>y</sub> [cm <sup>4</sup> ] | 0.70 |
| Section modulus W <sub>x</sub> [cm <sup>3</sup> ]   | 0.70 |
| Section modulus W <sub>y</sub> [cm <sup>3</sup> ]   | 0.70 |
| Weight m [kg/m]                                     | 0.50 |

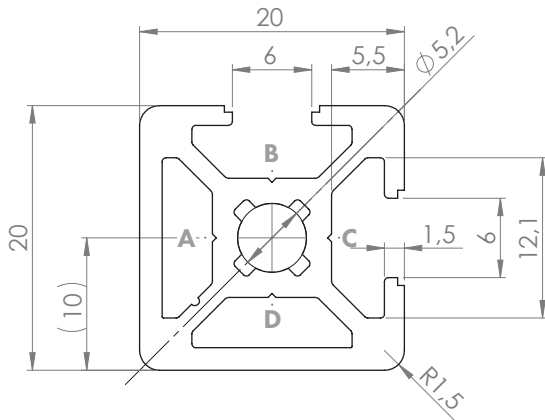

| Standard processing: | Art. no.: |
|----------------------|-----------|
| M6 / -               | 103150    |
| M6 / M6              | 103151    |
| D5.8 / -             | 102096    |
| D5.8 / D5.8          | 102097    |
| D5.8+ /              | 102095    |
| D5.8+ / D5.8+        | 102094    |
|                      |           |
|                      |           |
|                      |           |
|                      |           |

Explanations and further processing options can be found on p. 223-231

| Dimensions (version) | Length (mm)   | Slot | Weight (kg) | Art. no.: |
|----------------------|---------------|------|-------------|-----------|
| 20x20 2N90           | Cut to length | 6    | 0.5 kg/m    | 20100520  |
| 20x20 2N90           | 6060          | 6    | 0.5 kg/m    | 20100521  |

If this profile is cut to length, the cutting costs incurred per saw cut must be factored in. (Art. no.: 101010)

## COVER CAP 20x20 SLOT 6

Material: PA plastic

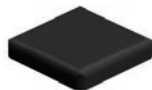

| Dimensions (version) | Slot | Weight (g) | Version | Art. no.: |
|----------------------|------|------------|---------|-----------|
| 20x20                | 6    | 4          | Black   | 401004    |