

## PROFILE 45x60 SLOT 10

Material: anodised aluminium

### Technical data:

Surface A [cm <sup>2</sup> ]	11.00
Moment of inertia I <sub>x</sub> [cm <sup>4</sup> ]	37.20
Moment of inertia I <sub>y</sub> [cm <sup>4</sup> ]	22.70
Section modulus W <sub>x</sub> [cm <sup>3</sup> ]	12.40
Section modulus W <sub>y</sub> [cm <sup>3</sup> ]	10.10
Weight m [kg/m]	3.00

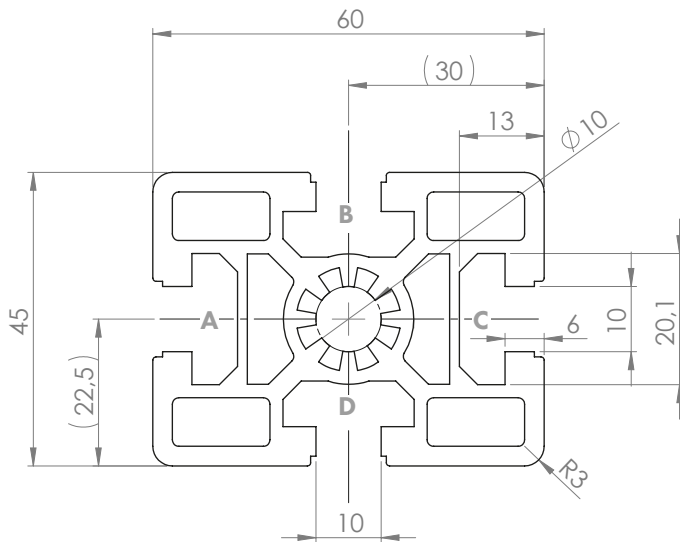

Standard processing:	Art. no.:
M12 / -	103300
M12 / M12	103305
D17 / -	102500
D17 / D17	102505
D17 / D17V	102515
D17V / D17V	102540
D17(SSV) / -	102380
D17(SSV) / D17(SSV)	102382
D9.8 / -	102300
D9.8 / D9.8	102305
D9.8+ / -	102315
D9.8+ / D9.8+	102325

Explanations and further processing options can be found on p. 223-231

Dimensions (version)	Length (mm)	Slot	Weight (kg)	Art. no.:
45x60	Cut to length	10	3.0 kg/m	20104000
45x60	6060	10	3.0 kg/m	20104001

If this profile is cut to length, the cutting costs incurred per saw cut must be factored in. (Art. no.: 101020)

## COVER CAP 45x60 SLOT 10

Material: PA plastic

Dimensions (version)	Slot	Weight (g)	Version	Art. no.:
45x60	10	11	Black	401040
45x60	10	10	Black with hole (Ø18.5)	401050